

Belt Maintenance and Installation

To get the maximum performance that is engineered into every Gates belt, be sure it is properly selected, installed and maintained. Gates offers two simple devices to help you achieve this.

Belt and Sheave Gauges

- Identifies correct cross section of belt
- Checks sheave grooves for signs of wear; signals need for replacement
- Guarantees correct fit of belt in sheave
- Eliminates belt damage caused by worn sheaves

Tension Tester

- Accurately measures drive tension
- Provides a chart of recommended deflection forces for each type of heavy-duty V-belt
- Eliminates under-tensioning, which causes slippage and reduces belt life
 - Prevents over-tensioning that can result in excessive wear on the entire drive system

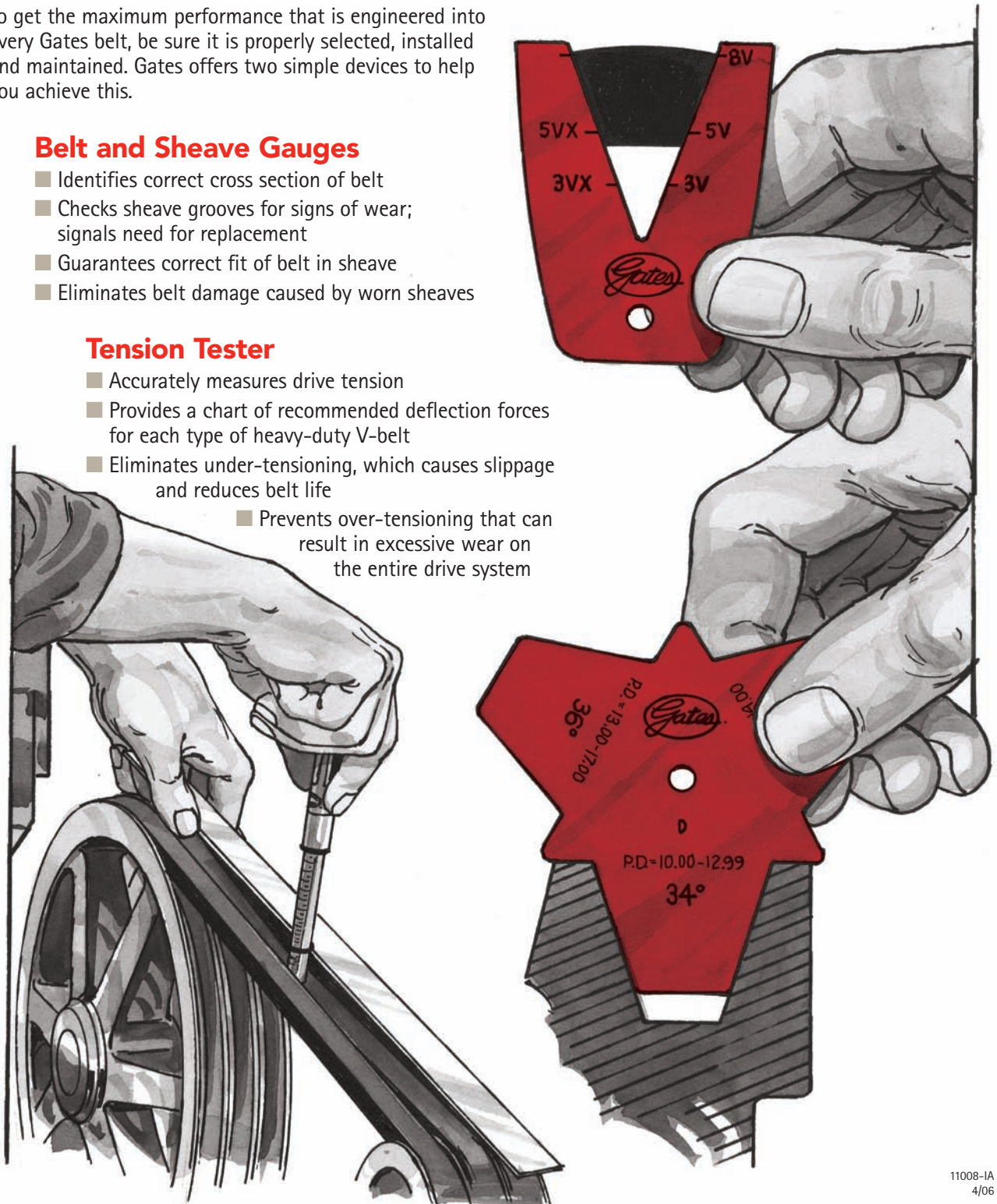

11008-1A
4/06

Voelzow & Company, Inc.

4804 Lawyers Rd E • Wingate, NC 28174
704-233-9222 • Fax 704-233-9211
E-mail: nvoelzow@perigee.net
Web: www.LaserAlignment.net

The Driving Force in Power Transmission®

Gates

A Tomkins Company

www.gates.com/pt